

BMR 53 > 12B-868R601 (2012) > GETRIEBE, MOTOR

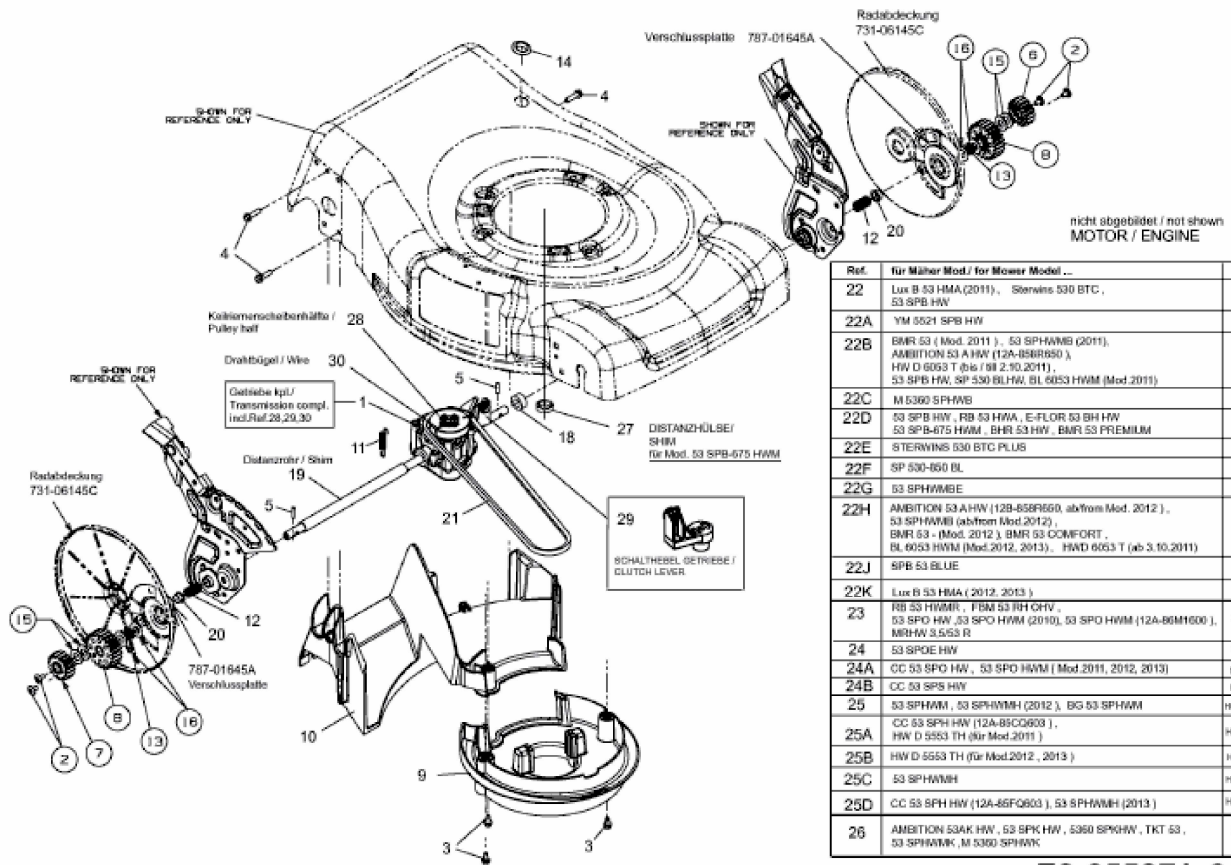

| Ref. | für Mäher Mod./ for Mower Model ... | |
|------|--|-------|
| 22 | Lux B 53 HMA (2011), Sterwins 530 BTC, 53 SPB HW | 845 |
| 22A | YM 5521 SPB HW | 845 |
| 22B | BMR 53 (Mod. 2011), 53 SPHMB (2011), AMBITION 53 A HW (12A-868R601), HW D 6053 T (ab / 08 2.10.2011), 53 SPB HW, SP 530 BLHW, BL 6053 HWM (Mod.2011) | 846 |
| 22C | M 5360 SPHMB | 846 |
| 22D | 53 SPB HW, RB 53 HWA, E-FLOR 53 BH HW, 53 SPB-675 HWM, BHR 53 HW, BMR 53 PREMIUM | 845 |
| 22E | STERWINS 530 BTC PLUS | 845 |
| 22F | SP 530-650 BL | 845 |
| 22G | 53 SPHMBE | 845 |
| 22H | AMBITION 53 AHW (12B-858R650, ab/from Mod. 2012), 53 SPHMB (ab/from Mod.2012), BMR 53 (Mod. 2012), BMR 53 COMFORT, BL 6053 HWM (Mod.2012, 2013), HWD 6053 T (ab 3.10.2011) | 845 |
| 22J | SPB 53 BLUE | 845 |
| 22K | Lux B 53 HMA (2012, 2013) | 845 |
| 23 | RB 53 HWMR, FBM 53 RH CHV, 53 SPO HW, 53 SPO HWM (2010), 53 SPO HWM (12A-868M1600), MRHW 3.5/53 R | MTD |
| 24 | 53 SPOE HW | MTD |
| 24A | CC 53 SPO HW, 53 SPO HWM (Mod.2011, 2012, 2013) | MTD |
| 24B | CC 53 SPS HW | MTD |
| 25 | 53 SPHAM, 53 SPHWMH (2012), BG 53 SPHWM | HONDA |
| 25A | CC 53 SPH HW (12A-85CG603), HW D 5553 TH (für Mod.2011) | HONDA |
| 25B | HW D 5553 TH (für Mod.2012, 2013) | HONDA |
| 25C | 53 SPHWMH | HONDA |
| 25D | CC 53 SPH HW (12A-85FG603), 53 SPHWMH (2013) | HONDA |
| 26 | AMBITION 53AK HW, 53 SPK HW, 5360 SPKHW, TKT 53, 53 SPHWMK, M 5360 SPHWMK | KAWA |

E3-05587A-01