

ZC-DHBB-3D5A-3DPX

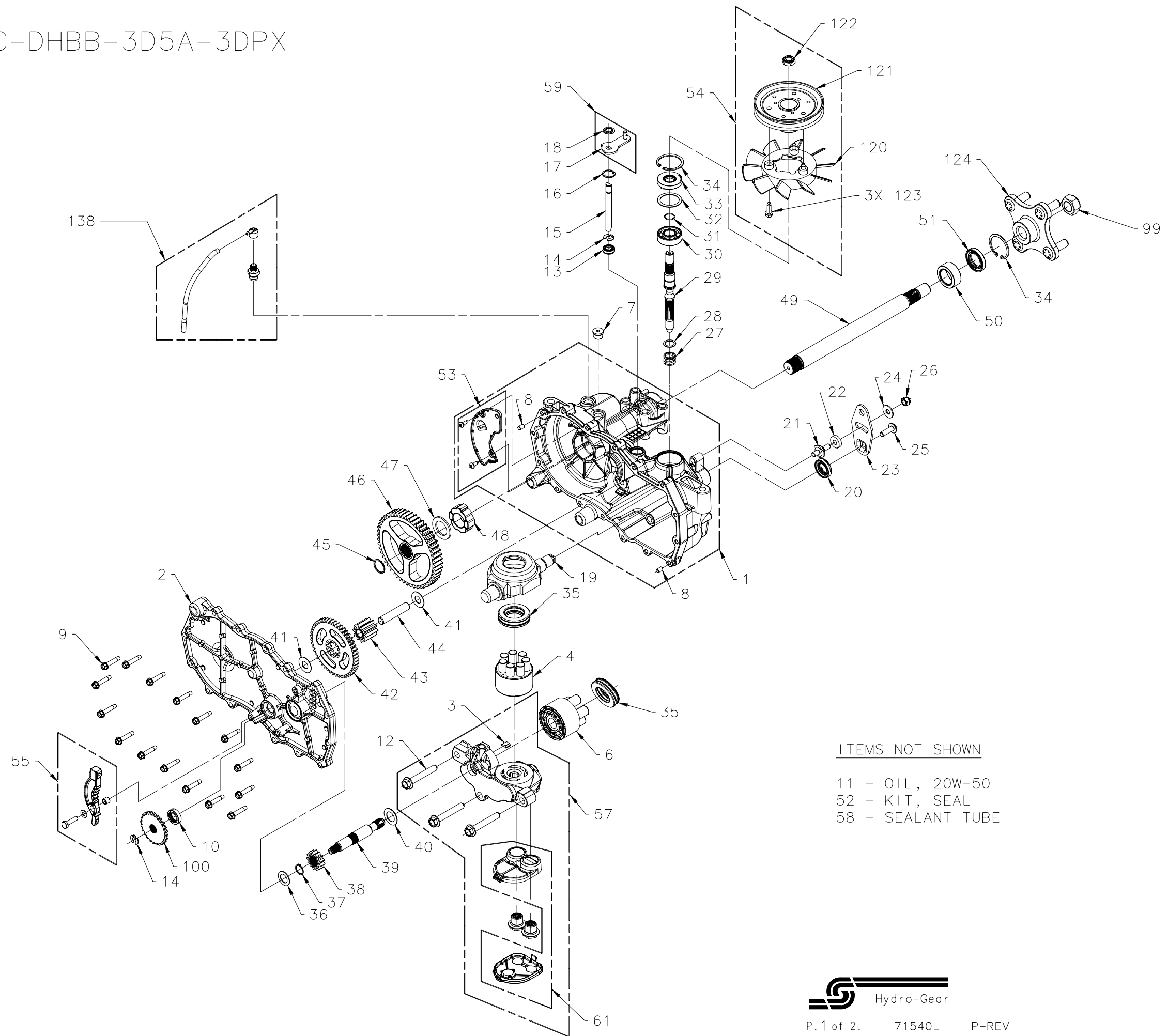

ITEMS NOT SHOWN

- 11 - OIL, 20W-50
- 52 - KIT, SEAL
- 58 - SEALANT TUBE



ZC-DHBB-3D5A-3DPX

ITEM	PART #	QTY	DESCRIPTION
1	70862L	1	ASSEMBLY, MAIN HOUSING-LH
			HOUSING, MAIN LH-MACHINED
			BUSHING, .865 X .985 X .790
			PLATE, EXPANSION LH
			SCREW, 10-32 X 1/2 (SELF-TAPPING)
			PIN, STANDARD, HEADLESS
			SEALANT TUBE, 10.3 oz
			SEAL, LIP .375 X .75 X .25
2	70863L	1	ASSEMBLY, SIDE-LH
			HOUSING, SIDE LH-MACHINED
			BUSHING, .624 X .719 X .562
			BUSHING, .865 X .985 X .790
3	51448	1	PLATE, BYPASS
4	70723	1	ASSEMBLY, PUMP BLOCK (7P-10CC)
			BLOCK, CYLINDER
			PISTON
			SPRING, COMPRESSION
			WASHER, THRUST
6	70331	1	ASSEMBLY, MOTOR BLOCK (5P-10CC)
			BLOCK, CYLINDER
			PISTON
			SPRING, COMPRESSION
			WASHER, THRUST
7	9005110-5600	1	PLUG, SAE #6
8	9004800-2506	2	PIN, STAINLESS, HEADLESS
9	51190	16	HFCS 1/4-20 X 1.25 (SELF-TAPPING)
10	70719	1	KIT, BRAKE SEAL
11		56 oz.	OIL, 20W-50
12	50016	3	BOLT, HEX FLANGE 3/8-24 X 2.5
13	51626	1	SEAL, LIP .375 X .75 X .25
14	51628	2	RING, RETAINING .375 EXT
15	51625	1	ROD, BYPASS
16	51627	1	RING, RETAINING .750 INT
17	52370	1	ARM, BYPASS
18	51630	1	RING, RETAINING .375 EXT (PUSHNUT)
19	51048	1	SWASHPLATE, TRUNNION, MACHINED
20	51140	1	SEAL, LIP 18 X 32 X 7
21	50426	1	STUD, SHORT 5/16-24
22	52298	1	PUCK, FRICTION
23	51631	1	ARM, CONTROL
24	44130	1	WASHER, FLAT 11/32 ID X 7/8 OD X 1/16
25	51812	1	TWHCS 5/16-24 X 1.0
26	50317	1	NUT, HEX LOCK 5/16-24 UNJF
27	2003014	1	SPRING-HELICAL COMPRESSION
28	2003017	1	WASHER .591 X .787 X .040
29	51062	1	SHAFT, INPUT
30	50315	1	BEARING, BALL 17MM ID X 40MM OD X 12MM
31	2000022	1	RING, RETAINING WIRE .561 ID
32	50951	1	SPACER
33	51161	1	SEAL, LIP 17 X 40 X 7
34	50329	2	RING, RETAINING
35	50551	2	BEARING, THRUST 30 X 52 X 13
36	44371	1	WASHER, FLAT 5/8 ID X 1.0 OD X .05

ITEM	PART #	QTY	DESCRIPTION
37	44145	1	RING, RETAINING
38	51130	1	GEAR, PINION, 13T
39	51632	1	SHAFT, MOTOR
40	51069	1	WASHER, MOTOR SHAFT .71 ID X 1.16 OD X .04
41	50132	2	WASHER, HT .5 ID X 1.0 OD X .032
42	51129	1	GEAR, 10T/48T
43	51043	1	GEAR, 10T JACKSHAFT
44	51083	1	PIN, JACKSHAFT
45	52531	1	RING, SPIRAL RETAINING
46	52541	1	GEAR, 52T BULL
47	52532	1	WASHER, 1.018 X 1.57 X .105
48	52542	1	BEARING, SLEEVE (INBOARD)
49	52528	1	SHAFT, AXLE
50	51517	1	BUSHING, AXLE
51	51518	1	SEAL, LIP, 1.00 X 1.57 X .25
52	70853	1	KIT, SEAL
(10)			SEAL, LIP .625 X 1.000 X .250
(13)			SEAL, LIP .375 X .75 X .25
(20)			SEAL, LIP 18 X 32 X 7
(33)			SEAL, LIP 17 X 40 X 7
(51)			SEAL, LIP .750 X 1.577 X .250
(51)			SEAL, LIP 1.00 X 1.577
(10)			SEAL, LIP .50 X .88 X .25
(18)			RING, RETAINING .375 EXT
(16)			RING, RETAINING .750 INT
(14)			RING, RETAINING .375 EXT
(34)			RING, RETAINING 1.56 INT
(31)			RING, RETAINING WIRE .561
(37)			RING, RETAINING .62 EXT
(90)			RING, RETAINING, SPIRAL
53	70868L	1	KIT, EXPANSION PLATE, LH
			PLATE, EXPANSION LH
			SCREW, 10-32 X 1/2 (SELF-TAPPING)
54	70591	1	KIT, FAN-PULLEY
			FAN, 6*, 10 BLADE
			PULLEY, 4.5*
			NUT, HEX LOCK 1/2-20 (NYLON INSERT)
			SCREW, HEX WASHER HEAD TAPPING 1/4-20 X .75
55	70865	1	KIT, BRAKE ARM
			ARM, PARKING BRAKE
			WASHER .28 X .50 X .063
			BOLT, 1/4-20 X 1 W/PATCH
			BUSHING, .260 X .394 X .330
57	71529	1	KIT, CENTER SECTION-FILTER LH
			CENTER SECTION, LH-MACHINED
			BUSHING, .707 X .788 X .591
			PLATE, BYPASS
			BOLT, HEX FLANGE 3/8-24 X 2.5
			FILTER, BASE
			CHECK PLUG ASSEMBLY .027, WASHER
			ASSEMBLY, COVER
58	50928	1	SEALANT TUBE, 10.3 oz

ITEM	PART #	QTY	DESCRIPTION
59	71006	1	KIT, BYPASS ARM
			ARM, BYPASS
			RING, RETAINING .375 EXT (PUSHNUT)
61	70911	1	KIT, FILTER
			FILTER, BASE
			ASSEMBLY, COVER
99	50863	1	NUT, HEX 3/4-16
100	51635	1	DISC, COG BRAKE
112	51401	1	HOSE, .5 X 4.0
115	50590	1	PINCH CLAMP, SINGLE EAR
120	51365	1	FAN, 6*, 10 BLADE
121	50302	1	HUB PULLEY KIT 4.5*
122	51244	1	HEX LOCK NUT, 1/2-20 (NYLON INSERT)
123	50752	3	HEX WASHER HEAD TAPPING SCREW 1/4-20 X .25
124	70314	1	ASSEMBLY, HUB
			HUB
			STUD, 1/2-20 X 1.5 (RIBBED)
138	71510	1	KIT, BREATHER
			CAP, BARBED VENT
			FITTING, O-RING ASSEMBLY
			HOSE, EXPANSION TANK

