

TG-BCC1-BCC1-11HX

SECOND PUMP

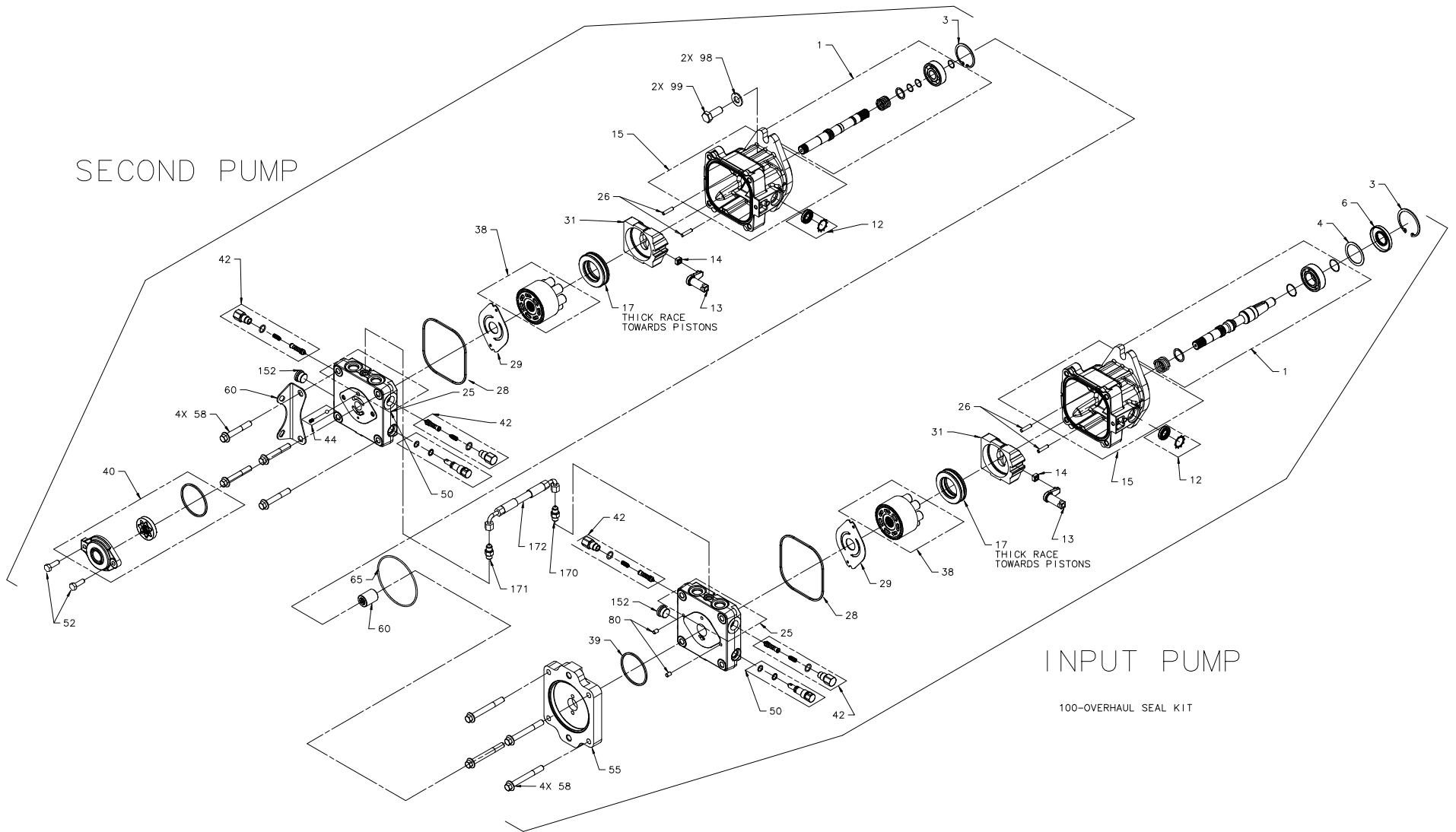

TG-BCC1-BCC1-11HX

INPUT PUMP

ITEM	PART #	QTY	DESCRIPTION
1	70606	1	KIT, AXLE (7/8" KEYED TAPERED)
		1	INPUT SHAFT - 7/8" KEYED TAPERED
		2	RETAINING RING - WIRE
		1	BEARING, BALL
		1	WASHER, THRUST
		1	SPRING, HELICAL COMPRESSION
3	51596	1	RETAINING RING - 52mm
4	51279	1	SPACER
6	51260	1	SEAL, LIP 17 X 47 X PTCN1
12	70739	1	KIT, TRUNNION SEAL
		1	RETAINING RING - TRUNNION SEAL
		1	SEAL, LIP 15 X 27 X 5
13	51596	1	TRUNNION ARM (TAPER SQUARE)
14	2000015	1	SLOT GUIDE
15	70528	1	KIT, HOUSING
		1	HOUSING - MACHINED
		2	BEARING, CRADLE
		1	BEARING, JOURNAL
17	50552	1	BEARING, THRUST
25	70529	1	KIT, END CAP (TANDEM)
		1	END CAP (TANDEM)
		1	BEARING, NEEDLE (SHAFT)
26	50641	2	PIN, HEADLESS
28	50381	1	GASKET, HOUSING
29	51764	1	VALVE PLATE
31	50203	1	SWASHPLATE
38	70082	1	KIT, CYLINDER BLOCK - MOTOR
		1	CYLINDER BLOCK - MOTOR
		7	SPRING, PISTON
		7	PISTON
		7	PISTON SPRING SEAT
39	51016	1	R-RING - 144 (STD CHG)
42	70743	2	KIT, SHOCK VALVE (200 BAR, .031 ORIFICE)
		1	SHOCK VALVE
		1	PLUG, SHOCK VALVE
		1	SPRING, COMPRESSION (SHOCK-CHECK)
		2	O-RING
50	2513030	1	BYPASS VALVE KIT
		1	BYPASS VALVE (NO ORIFICE)
		1	O-RING
		1	RING, BACK-UP
55	51272	1	PLATE, ADAPTER (TANDEM)
58	51826	4	HEX SCREW, FH M10
80	9004800-2506	2	PIN, HEADLESS
152	9005110-7500	1	PLUG - 3/4-16 STEEL

SECOND PUMP

ITEM	PART #	QTY	DESCRIPTION
1	70607	1	KIT, AXLE (20T 32/64 TO 20T 32/64 SPLINE)
		1	INPUT SHAFT - 20T 32/64 TO 20T 32/64 SPLINE
		3	RETAINING RING - WIRE
		1	BEARING, BALL
		1	WASHER, THRUST
		1	SPRING, HELICAL COMPRESSION
3	2000038	1	RETAINING RING - 47mm
12	70739	1	KIT, TRUNNION SEAL
		1	RETAINING RING - TRUNNION SEAL
		1	SEAL, LIP 15 X 27 X 5
13	51596	1	TRUNNION ARM (TAPER SQUARE)
14	2000015	1	SLOT GUIDE
15	70533	1	KIT, HOUSING
		1	HOUSING - MACHINED
		2	BEARING, CRADLE
		1	BEARING, JOURNAL
17	50552	1	BEARING, THRUST
25	2510066	1	KIT, END CAP (TANDEM)
		1	END CAP (TANDEM)
		1	BEARING, NEEDLE (SHAFT)
		1	PLUG - 5/16-24 STEEL
26	50641	2	PIN, HEADLESS
28	50381	1	GASKET, HOUSING
29	51764	1	VALVE PLATE
31	50203	1	SWASHPLATE
38	70082	1	KIT, CYLINDER BLOCK - MOTOR
		1	CYLINDER BLOCK - MOTOR
		7	SPRING, PISTON
		7	PISTON
		7	PISTON SPRING SEAT
40	2510071	1	KIT, CHARGE PUMP
		1	CHARGE PUMP HOUSING
		1	GEROTOR ASSY .19 CI/REV
		1	R-RING - 144 (STD CHARGE)
42	70743	2	KIT, SHOCK VALVE (200 BAR, .031 ORIFICE)
		1	SHOCK VALVE
		1	PLUG, SHOCK VALVE
		1	SPRING, COMPRESSION (SHOCK-CHECK)
		2	O-RING
44	70402	1	KIT, CHARGE RELIEF
		1	SPRING, CHARGE RELIEF
		1	BALL, CHECK RELIEF
50	2513030	1	BYPASS VALVE KIT
		1	BYPASS VALVE (NO ORIFICE)
		1	O-RING
		1	RING, BACK-UP
52	9007200-3116	2	SCREW, M8 X 1.25 X 25mm LONG
58	51457	4	HEX SCREW, FH M10
60	51593	1	MOUNTING BRACKET
152	9005110-7500	1	PLUG - 3/4-16 STEEL

MISC. COMPONENTS

ITEM	PART #	QTY	DESCRIPTION
60	51275	1	COUPLING 20T 32/64
65	51300	1	O-RING, .103 X 3.987 ID
98	51265	2	WASHER, 1/2 SAE
99	51286	2	HHCS, 1/2-13 X 1.25 LONG
110	70531	1	KIT, SEAL OVERHAUL
170	51310	1	FITTING, 7/16 SAE ST-JIC
171	51310	1	FITTING, 7/16 SAE ST-JIC
172	51311	1	HOSE ASSY - 7.1 LONG