

788786  
313-2600R

80 - 20W-50 OIL  
100 - SEALANT  
134 - SEAL KIT

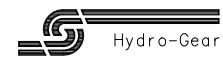
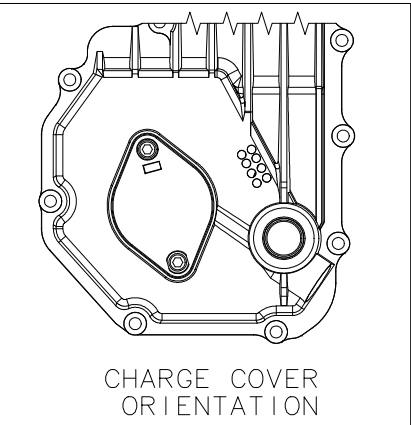
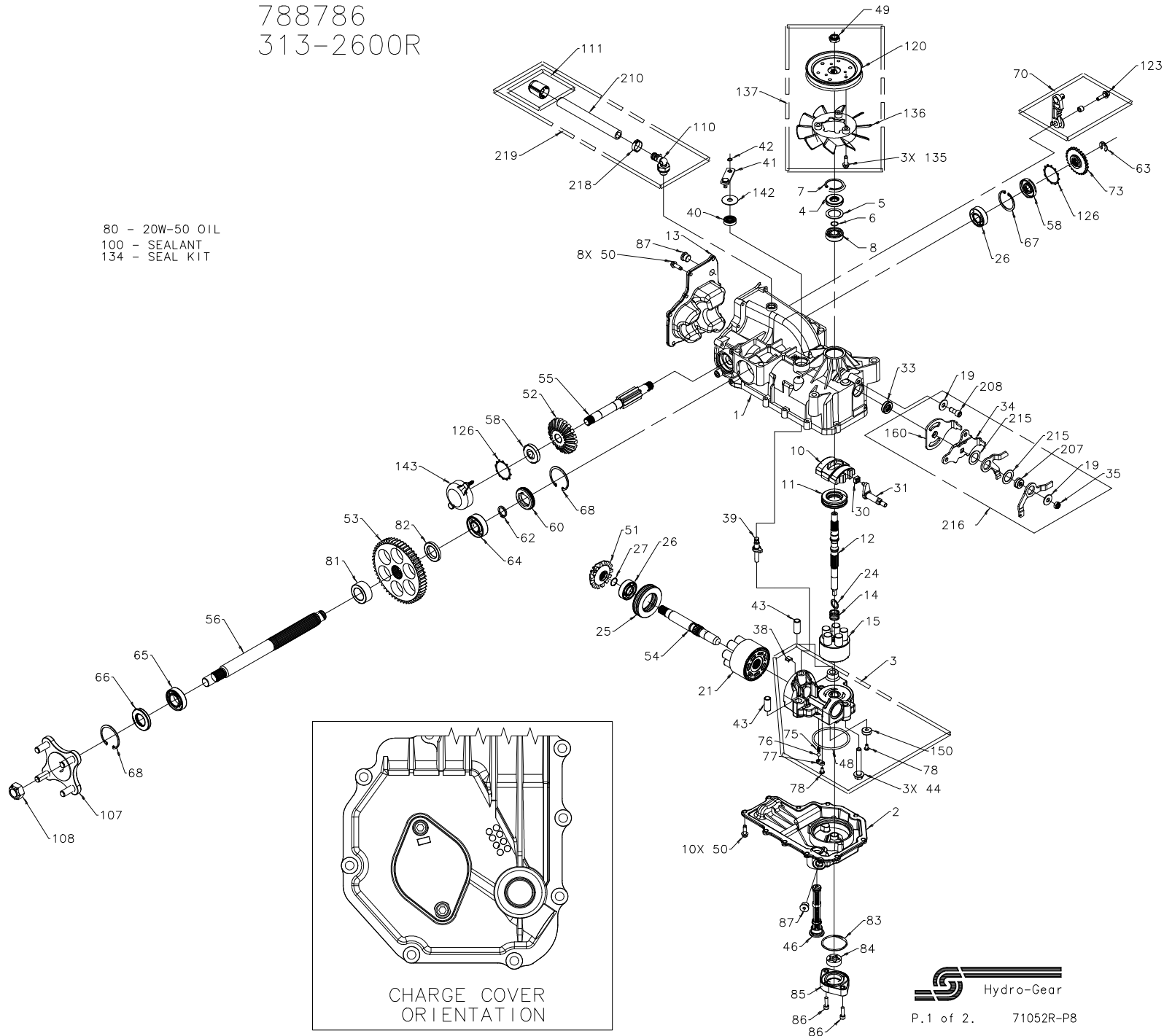

788786  
313-2600R

| ITEM # | PART #       | QTY | DESCRIPTION                        |
|--------|--------------|-----|------------------------------------|
| 1      | 70627        | 1   | KIT, HOUSING-MAIN                  |
|        |              | 1   | HOUSING, MAIN                      |
|        |              | 2   | BEARING, CRADLE                    |
|        |              | 1   | BUSHING, TRUNNION                  |
|        |              | 1   | SEAL, LIP 12 X 25 X 7              |
|        |              | 1   | SCREW, HFHC 1/4-28 X 7/8 (PATCH)   |
| 2      | 51866        | 1   | HOUSING, LOWER                     |
| 3      | 70903        | 1   | KIT, CENTER SECTION                |
|        |              | 1   | CENTER SECTION                     |
|        |              | 1   | BUSHING .673 X 1.03 X .75          |
|        |              | 1   | PLATE, BYPASS                      |
|        |              | 3   | HFHCS, 3/8-24 X 2.5 (PATCH)        |
|        |              | 1   | ASSEMBLY, SHOCK VALVE .027         |
|        |              | 1   | ASSEMBLY, SHOCK VALVE .044         |
|        |              | 1   | SPRING, CHARGE RELIEF              |
|        |              | 1   | BALL, 1/4                          |
|        |              | 1   | O-RING, .139 X 2.984 X 7           |
|        |              | 1   | PLATE, RELIEF                      |
|        |              | 2   | BOLT, SELF-TAPPING 10-32 X .5      |
|        |              | 1   | MAGNET, RING                       |
| 4      | 9008000-0128 | 1   | LIP SEAL                           |
| 5      | 2003018      | 1   | SPACER                             |
| 6      | 2003016      | 1   | WIRE RETAINING RING                |
| 7      | 2003052      | 1   | RETAINING RING                     |
| 8      | 2003043      | 1   | BALL BEARING                       |
| 10     | 2003087      | 1   | VARIABLE SWASHPLATE                |
| 11     | 50551        | 1   | THRUST BEARING 30 X 52 X 13        |
| 12     | 51771        | 1   | SHAFT, INPUT                       |
| 13     | 52169        | 1   | END COVER WITH DRAIN               |
| 14     | 2003014      | 1   | SPRING, BLOCK                      |
| 15     | 70331        | 1   | 10cc CYLINDER BLOCK ASS'Y          |
|        |              | 1   | 10cc CYLINDER BLOCK                |
|        |              | 5   | 10cc PISTON SPRING                 |
|        |              | 5   | PISTON SEAT WASHER                 |
|        |              | 5   | 10cc PISTON                        |
| 19     | 44130        | 1   | WASHER                             |
| 21     | 70082        | 1   | 21cc CYLINDER BLOCK ASS'Y          |
|        |              | 1   | 21cc CYLINDER BLOCK                |
|        |              | 7   | 21cc PISTON SPRING                 |
|        |              | 7   | PISTON SEAT WASHER                 |
|        |              | 7   | 21cc PISTON                        |
| 24     | 2003017      | 1   | WASHER, BLOCK THRUST               |
| 25     | 50552        | 1   | THRUST BEARING 42 X 68 X 16        |
| 26     | 50315        | 2   | BALL BEARING                       |
| 27     | 2000022      | 1   | WIRE RETAINING RING                |
| 30     | 2000015      | 1   | SLOT GUIDE                         |
| 31     | 50807        | 1   | TRUNNION ARM                       |
| 33     | 9008000-0126 | 1   | LIP SEAL                           |
| 34     | 51394        | 1   | ARM, CONTROL                       |
| 35     | 50108        | 2   | NUT                                |
| 38     | 70680        | 1   | KIT, BYPASS PLATE                  |
| 39     | 2003555      | 1   | BYPASS ACTUATOR                    |
| 40     | 45074        | 1   | LIP SEAL                           |
| 41     | 50270        | 1   | BYPASS ARM                         |
| 42     | 44870        | 1   | RETAINING RING                     |
| 43     | 50002        | 2   | PIN                                |
| 44     | 50016        | 3   | SCREW                              |
| 46     | 51931        | 1   | ASSEMBLY, FILTER                   |
| 49     | 51244        | 1   | HEX LOCK NUT 1/2-20 (NYLON INSERT) |
| 50     | 50752        | 18  | SCREW, 1/4-20 X .75 LONG           |
| 51     | 50744        | 1   | 14T BEVEL GEAR                     |
| 52     | 50745        | 1   | 19T BEVEL GEAR                     |

| ITEM # | PART #       | QTY  | DESCRIPTION                        |
|--------|--------------|------|------------------------------------|
| 53     | 50746        | 1    | 53T SPUR GEAR                      |
| 54     | 50757        | 1    | MOTOR SHAFT                        |
| 55     | 51298        | 1    | BRAKE SHAFT                        |
| 56     | 50748        | 1    | AXLE SHAFT                         |
| 58     | 51161        | 2    | SEAL, LIP 17 X 40 X 7              |
| 60     | 50995        | 1    | SEAL PLUG - SIDE                   |
| 62     | 50759        | 1    | RETAINING RING - AXLE              |
| 63     | 51109        | 1    | RETAINING RING                     |
| 64     | 50743        | 1    | BEARING-BALL 20X47X14(6204)        |
| 65     | 50740        | 1    | BEARING-BALL 25X47X12(6005)        |
| 66     | 50751        | 1    | SEAL                               |
| 67     | 50329        | 1    | RETAINING RING                     |
| 68     | 50760        | 2    | RETAINING RING-AXLE                |
| 70     | 71088        | 1    | RH, BRAKE ARM SERVICE ASSEMBLY     |
|        |              | 1    | BRAKE ARM                          |
|        |              | 1    | CLEVIS PIN                         |
|        |              | 1    | BUSHING .255 X .381 X .330         |
| 73     | 50754        | 1    | SCREW, HFHC 1/4-20 X 7/8 (PATCH)   |
| 80     |              | 1    | BRAKE DISC                         |
| 81     | 51939        | 79oz | 20W-50 OIL                         |
| 82     | 51940        | 1    | WASHER, AXLE 1.04 X 1.65 X .22     |
| 83     | 9004101-1340 | 1    | WASHER, AXLE 1.04 X 1.65 X .70     |
| 84     | 50273        | 1    | O-RING .103 X 1.862                |
| 85     | 50260        | 1    | ASSEMBLY, GEROTOR                  |
| 86     | 50095        | 1    | COVER GEROTOR                      |
| 87     | 9005110-5600 | 2    | SHCS M6 X 20                       |
| 100    | 50928        | 1    | PLUG, 9/16-18 (METAL)              |
| 107    | 70314        | 1    | SEALANT                            |
|        |              | 1    | HUB ASSEMBLY                       |
|        |              | 1    | HUB                                |
|        |              | 4    | LUG BOLT                           |
| 108    | 50863        | 1    | NUT, HEX 3/4-16                    |
| 110    | 51825        | 1    | FITTING, 90° PLASTIC               |
| 111    | 70921        | 1    | CAP-VENT ASSEMBLY                  |
|        |              | 1    | CAP-POPPET VALVE                   |
|        |              | 1    | ST .5 BARB VENT                    |
| 120    | 52039        | 1    | PULLEY, 4.50 INCH                  |
| 123    | 51576        | 1    | SCREW, HFHC 1/4-20 X 7/8 (PATCH)   |
| 126    | 51316        | 2    | RING, RETAINING                    |
| 134    | 70553        | 1    | KIT, SEAL                          |
|        |              | 1    | SEAL, LIP 15 X 35 X 7              |
|        |              | 1    | RING, RETAINING 37 INT             |
|        |              | 1    | SEAL, LIP 12 X 25 X 7              |
|        |              | 1    | SEAL, LIP 10 X 25 X 7              |
|        |              | 1    | RING, RETAINING .31 EXT            |
|        |              | 18   | HFHCS 1/4-20 X .75                 |
|        |              | 1    | SEAL PLUG                          |
|        |              | 2    | RING, RETAINING .75 EXT            |
|        |              | 1    | RING, RETAINING .440 EXT           |
|        |              | 1    | SEAL, LIP 25 X 47 X 7              |
|        |              | 1    | RING, RETAINING 1.56 INT           |
|        |              | 2    | RING, RETAINING 1.87 INT           |
|        |              | 2    | RING, RETAINING 1.43               |
| 135    | 50752        | 1    | SCREW, SELF-TAPPING 1/4-20 X .75   |
| 136    | 51365        | 1    | FAN, 6", 10 BLADE                  |
| 137    | 71140        | 1    | KIT, FAN-PULLEY                    |
|        |              | 3    | SCREW, SELF-TAPPING 1/4-20 X .75   |
|        |              | 1    | FAN, 6", 10 BLADE                  |
|        |              | 1    | HEX LOCK NUT 1/2-20 (NYLON INSERT) |
|        |              | 1    | PULLEY, 4.50 INCH                  |

| ITEM # | PART # | QTY | DESCRIPTION                               |
|--------|--------|-----|---|
| 142    | 51813  | 1   | WASHER .39 X 1.27 X .05                   |
| 143    | 51774  | 1   | CAP, BRAKE                                |
| 150    | 51100  | 1   | MAGNET, RING                              |
| 160    | 51391  | 1   | ARM, RETURN                               |
| 207    | 51604  | 1   | SPACER, RTN                               |
| 208    | 51400  | 1   | SHCS 5/16-24 X .75 (PATCH)                |
| 210    | 52040  | 1   | HOSE $\phi$ .50 X 6.50                    |
| 215    | 51408  | 2   | WASHER, PLASTIC 1.19 X .7                 |
| 216    | 71326  | 1   | KIT, RETURN                               |
|        |        | 2   | WASHER                                    |
|        |        | 1   | CONTROL ARM                               |
|        |        | 1   | HEX LOCK NUT, 5/16-24 INJF (NYLON INSERT) |
|        |        | 1   | ARM, RTN SCISSOR, OUTER                   |
|        |        | 1   | ARM, CW RTN SCISSOR, INNER                |
|        |        | 1   | ARM, RETURN                               |
|        |        | 1   | SPACER, RTN                               |
|        |        | 1   | SCREW, 5/16-24 X .74 (PATCH)              |
|        |        | 2   | WASHER, NYLON                             |
|        |        | 1   | CLAMP, PINCH, SINGLE EAR 13/16            |
| 218    | 50590  | 1   | KIT, BREATHER                             |
| 219    | 71322  | 1   | PINCH CLAMP, SINGLE EAR                   |
|        |        | 1   | VENT, PLASTIC                             |
|        |        | 1   | FITTING, 9/16 90°                         |
|        |        | 1   | CAP, PLASTIC                              |
|        |        | 1   | HOSE, $\phi$ .50 X 6.50                   |

